



**SPeed
Your Diag**

**Rapid Microbiology
Kits RNA GenoSPYD real time RT-PCR**

GenoSPYD

**TVC (Total Viable
Bacteria Count)**
**TYMC (Total Viable
Yeast & Mold Count)**

Our Solutions

- **GenoSPYD** : rapid microbiology (extraction + RT Q-PCR)
- **MagSPYD** : manual or automated (1 to 96 prep or 1 to 16) for total RNA/DNA extraction

Water testing - Beverage Testing

Fermentation / Stem Cell manufacturing QC

Water/liquid Pharma/Cosmetic Testing

Endoscope Testing

Hygien Testing

Rapid tests

- detection in < 3 hours of **spécific ARNs** from viable organisms: TBC, TYMC, E.coli, Enterococcus spp. , Staphylococcus aureus, Pseudomonas aeruginosa...

-quantitative & sensitive methods

- Our products have been developed and validated with KOL (key opinion leader) in industries and clinics .



Our platform

- **Vortex** or



- **Minily**

3 positions



- **or Precelys**

24 positions



- **MagSPYD IDEAL**

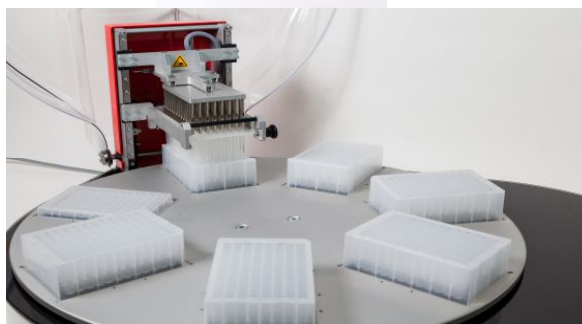

96 prep

- **MIC PCR machin**



48 positions
2 kg/ - 20 cm/20cm
bluetooth
pre-loaded PCR tubes

96 wells format

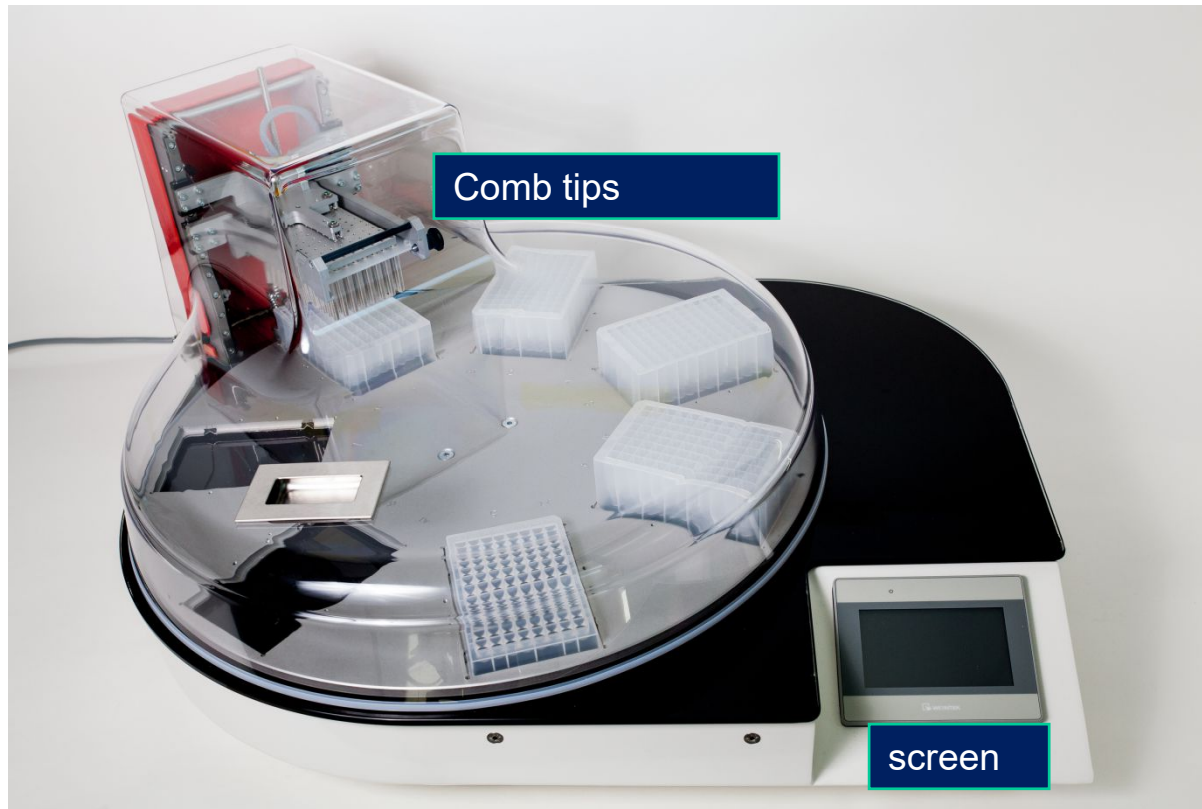

Carrousel format



no fluidic – only
mechanical
Up to 8 ml (plasma ,
urine)
35 mn for DNA/RNA
extraction
Elution in 100 μ l

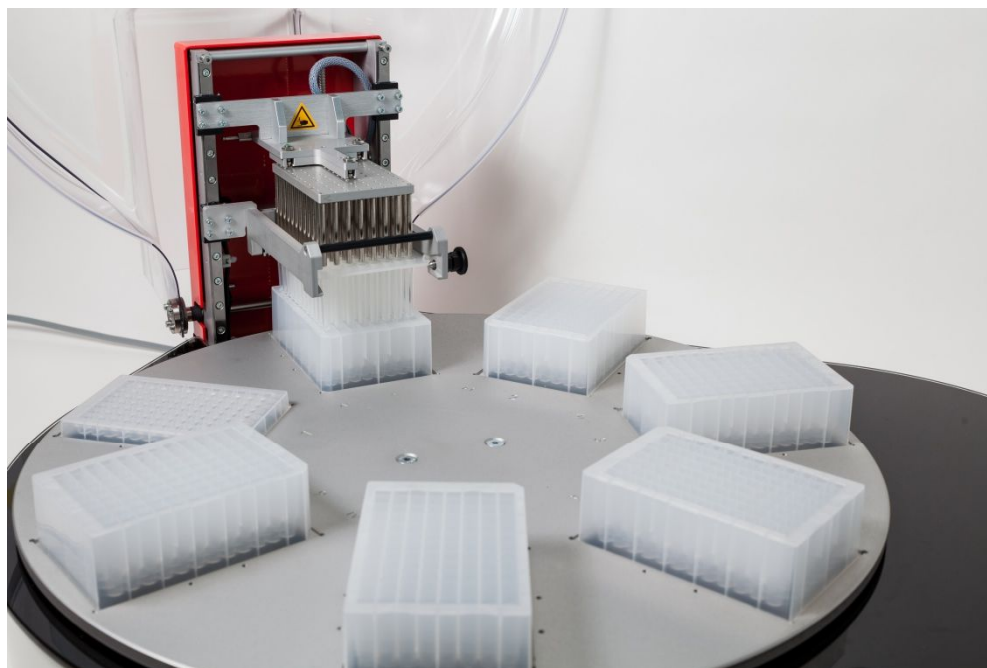

Technical specifications

Parameters	MagSPYD 24-96
Throughput	1-96 samples
Processing volume per well	500-5000 μ l
Maximum number of samples / cycle	24-96 samples up to 8 mL
Extraction time	Less than 1 hour
Collection efficiency of magnetic beads	>95%
Samples	RNA booster, media, water, urine, plasma, saliva
Internal software	HTML5
Dimensions	720x570x370 mm (WxDxh)
Sound intensity	<70dB
Electricity power	Power 460VA - Fuse 220V AC Intensity 2A - Frequency 50Hz
Manufacturing and conformity	France, CE standard

Key arguments

- **RAPID** : <3 hours
- **ONLY VIABLE ORGANISMS** : quantitative RNA dosage
- **PRELOADED PCR TUBES**: save time, easy to use
- **COST REDUCTION** : 1 RNA extraction, 1 RT –QPCR parameters (TBC, TMYC...)
- **A U T O M A T E D SOLUTION** : 1 to 96, no fluidic , reduced metrology
- **FLEXIBILITE** : manual or automated, reduced space,
- **SUPPORT** : on line support



MagSPYD versus King Fisher

- **TIME** : equivalent
- **CONSUMMABLE** : same plastics/ same BDC reagents
- **A U T O M A T E D PROGRAM WITHOUT COMPUTER** : screen interface
- **FLEXIBILITE** : reduced space
- **SUPPORT** : direct from BDC team in France
- **PRICE** : 38% less cost versus King Fisher ml equipment
- **REPAIR** : performed in France





**SPeed
Your Diag**

Available GenoSPYD kits

GenoSPYD

TVO

TYMC

E. Coli

Enterococcus spp.

Staphylococcus aureus

Pseudomonas aeruginosa

THANKS YOU - MERCI



info@bluednacompanion.com

www.bluednacompanion.com

